

DUST COVER

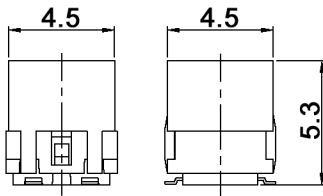

P.C.B. LAYOUT

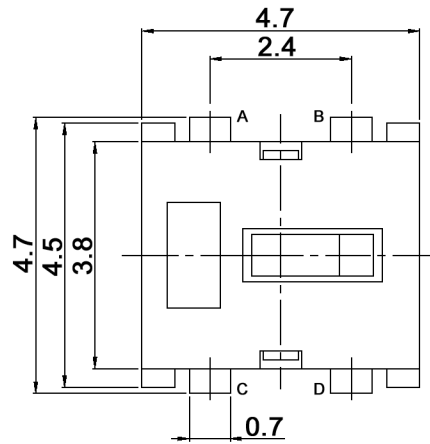
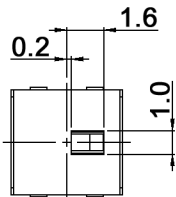
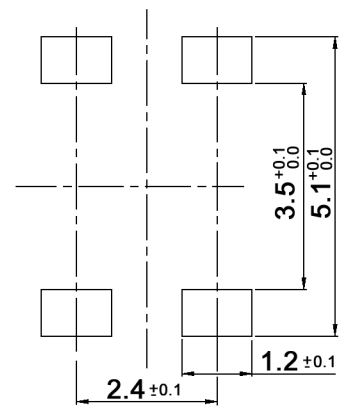

CIRCUIT DIAGRAM

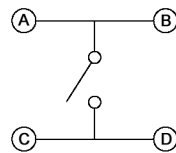

Compliance: RohS II (2011/65/EU)

Tolerances: max. ±0.20mm		Date	Name	<h1>DTS 312 C-T</h1>
		11/14	dr	
Temperatures	07/15	dr	<h2>30 32 21</h2>	Page
Material terminal	01/15	dr		1/2
Modifications	Date	Name	<b>knitter-switch</b>	

**Specifications:**

**Contact rating:** 1mA, 5V DC  
**Contact resistance:** 10hm max.  
**Insulation resistance:** 100MOhm min. at 100V DC for 1 minute +/-5sec.  
**Dielectric strength:** 100V AC (50/60Hz) for 1 minute  
**Operating temperature:** -40°C to +85°C  
**Storage temperature:** -40°C to +85°C  
**Electrical life:** 100 000 cycles min.  
**Operating force:** 40gf max.  
**Material:** Terminal: phosphor bronze, silver plated  
 Base: high-temp. thermoplastic PA9T, molded black  
 Contact: stainless steel, silver cladding  
 Stem / cover: high-temp. thermoplastic LCP, molded black

**Soldering conditions:**

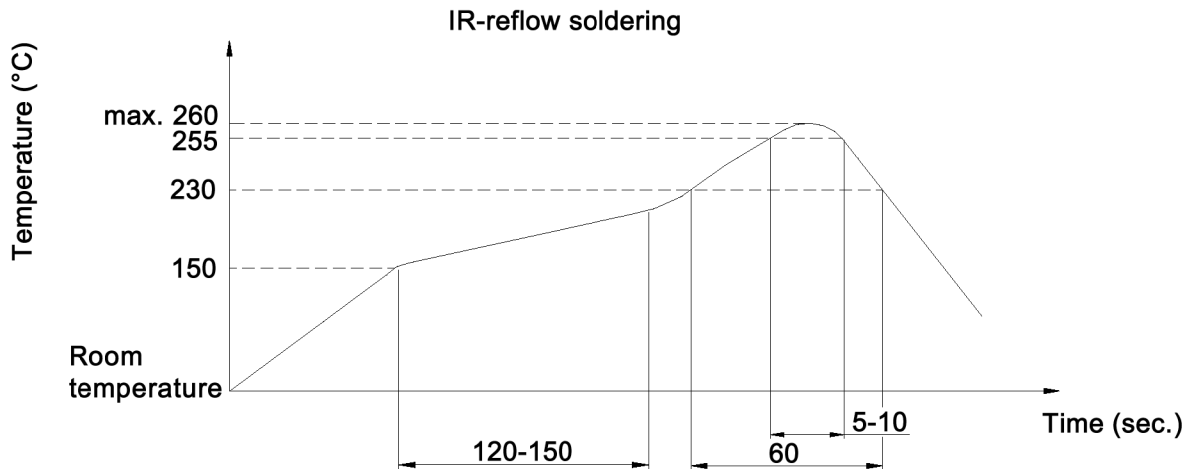

**Compliance: RohS II (2011/65/EU)**

Tolerances: max. ±0.20mm	Date	Name	<b>DTS 312 C-T</b>
	11/14	dr	
			<b>30 32 21</b>
			Page
			2/2
Modifications	Date	Name	